

## 60 cm freestanding bottom mount refrigerator, stainless steel Master-serien

SEK 19,995



### **RBM60F5FXNC**

This 60 cm freestanding bottom-mount refrigerator has a total capacity of 366 liters. The refrigerator is equipped with 4 shelves, 3 of which with variable height, 3 height-adjustable bins and 2 drawers with adjustable humidity. The ZeroFresco chiller drawer allows to better preserve your meat and fish at a temperature of around 0°C.

The Total No Frost cooling system avoids the formation of ice and bacteria. The LED touch interface has been designed for maximum ease of use. The LED illumination ensures perfect lighting on all levels.

PureBreeze UV technology eliminates 99.99% of bacteria and viruses with UV-C LED rays, while the activated carbon filter effectively filters odors and improves air quality, keeping the atmosphere of the refrigerator cool.

Using one of the 2 available handle kits in Professional and Master Series style, this refrigerator integrates seamlessly with all other Bertazzoni appliances into style-harmonized suites for a true, high-performing kitchen.

E energy class.

[Guarda online](#)

# Specifikationer

## Funktioner

### Allmänna egenskaper

Standby-läge	60 cm
Kylsystem	Totalt Ingen Frost
Användargränssnitt	internt digitalt LED-pekgränssnitt
Visa funktioner	Super freeze, Eco mode
Belysning	LED lighting
Larm för öppen dörr	yes
Efterbehandling av dörrar	rostfritt stål
Efterbehandling av skåp	vit
Kylskåpets nettokapacitet	266 L
Antal hyllor	4 höjdbarbara + 1 fast
Kylskåp lådor	1 with adjustable humidity + 1 FrescoZero with separate temperature and humidity control
Lagerplatser	1 gallon storlek + 3 höj- och sänkbara behållare
Frysens nettokapacitet	100 L
Fryslådor	3
Ljud betyg	41 dbA

### Tekniska specifikationer

Energiklass	E
Spänning och frekvens	220-240V, 50 Hz
Absorberad effekt (W)	180 W
Årlig energiförbrukning (kWh)	250

# Mått

## PRODUCT DIMENSIONS

SIDE VIEW

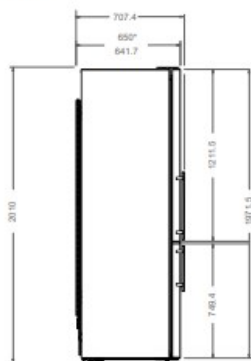

FRONT VIEW

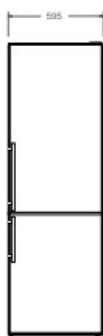

TOP VIEW

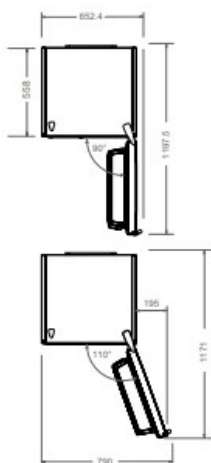

\* with condenser

## CUTOUT DIMENSIONS

SIDE VIEW

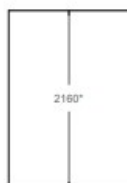

\* dimension with a minimum clearance of 150 mm on top

FRONT VIEW

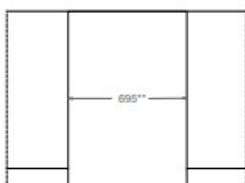

\*\* dimension with a minimum clearance of 50 mm on both sides

TOP VIEW



\*\*\* dimension with a minimum clearance of 15 mm on back